

UQA-21035

Quantum 2 Double Head Streetlight

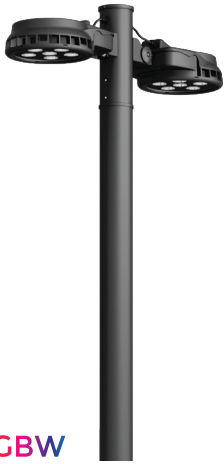

2x77w LED
2x3012 Lumens

IP66
Suitable for wet locations

IK08
Impact Resistant [Vandal Resistant]

EPA - 1.67

Weight 44 lbs

POLE NOT INCLUDED

RGBW

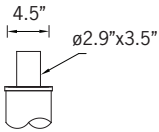
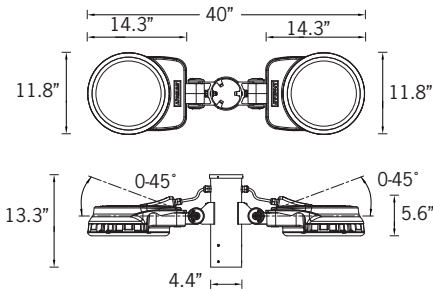

Tenon Detail

Construction

Aluminum

Less than 0.1% copper content - Marine Grade 6060 extruded & LM6 Aluminum High Pressure die casting provides excellent mechanical strength, clean detailed product lines and excellent heat dissipation.

Pre paint

8 step degrease and phosphate process that includes deoxidizing and etching as well as a zinc and nickel phosphate process before product painting.

Memory Retentive -Silicon Gasket

Provided with special injection molded "fit for purpose" long life high temperature memory retentive silicon gaskets. Maintains the gaskets exact profile and seal over years of use and compression.

Thermal management

LM6 Aluminum is used for its excellent mechanical strength and thermal dissipation properties in low and high ambient temperatures. The superior thermal heat sink design by Ligman used in conjunction with the driver, controls thermals below critical temperature range to ensure maximum luminous flux output, as well as providing long LED service life and ensuring less than 10% lumen depreciation at 50,000 hours.

Surge Suppression

Standard 10kv surge suppressor provided with all fixtures.

BUG Rating

B4 - U1 -G0

Finishing

All Ligman products go through an extensive finishing process that includes fettling to improve paint adherence.

Paint

UV Stabilized 4.9Mil thick powder coat paint and baked at 200 Deg C. This process ensures that Ligman products can withstand harsh environments. Rated for use in natatoriums.

Hardware

Provided Hardware is Marine grade 316 Stainless steel.

Anti Seize Screw Holes

Tapped holes are infused with a special anti seize compound designed to prevent seizure of threaded connections, due to electrolysis from heat, corrosive atmospheres and moisture.

Crystal Clear Low Iron Glass Lens

Provided with tempered, impact resistant crystal clear low iron glass ensuring no green glass tinge.

Optics & LED

Precise optic design provides exceptional light control and precise distribution of light. LED CRI > 80

Lumen - Maintenance Life

L80 /B10 at 50,000 hours (This means that at least 90% of the LED still achieve 80% of their original flux)

Adjustable column-mounted technical projector solution. Flexible technical project solutions in attractive column-downlight using the Stylish premium Quantum projectors.

This modern shaped medium sized pole mounted Quantum series brings a new look to Ligman outdoor street and parking area luminaires. This series offers premium Ligman symmetrical light distribution optics, as well as type II, III & IV light distributions.

This luminaire can tilt adjusted up to 80 degrees to provide onsite adjustment to optimize the light distribution to specific design requirements. This product could also be used for building facade lighting. An example of this could be a two head unit with type II distribution for the roadway with a type V floodlight optics aimed at the building for facade lighting.

Designed for contemporary city scapes, architectural office building areas, public areas, and civic plazas. Quantum offers the specifier a new look with well controlled lighting optics.

The luminaire is provided with integral driver. Provided with static white color temperature 2700K, 3000K, 3500K and 4000K. LED CRI >80 and life time 50,000 Hours.

This fixture is also available in RGBW in type V distributions.

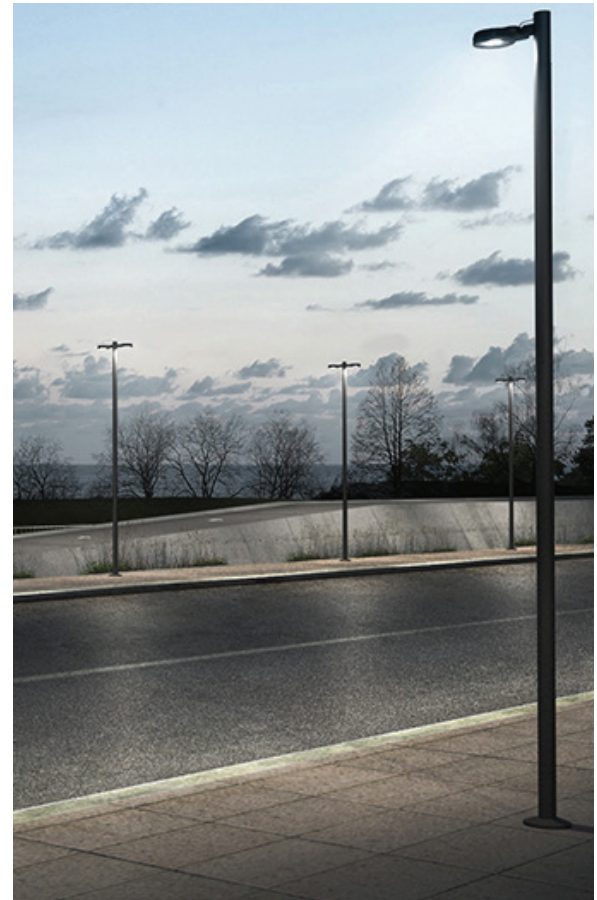

UQA-21035

Quantum 2 Double Head Streetlight

| | | | |
|----------------|--|-------------|--|
| PROJECT | | DATE | |
|----------------|--|-------------|--|

| | | | | | |
|-----------------|--|-------------|--|-------------|--|
| QUANTITY | | TYPE | | NOTE | |
|-----------------|--|-------------|--|-------------|--|

ORDERING EXAMPLE || UQA - 21035 - 2x77w - N - RGBW30 - 02 - 120/277v - Options

| LAMP | BEAM | RGBW COLOR | FINISH COLOR | VOLTAGE |
|----------------------------|--|--|---|-----------------------------|
| 2x77w LED 2x3012 Lumens | N - Narrow 20° M - Medium 35° E - Elliptical 25°x48° | RGBW30 - Warm White 3200K RGBW40 - Neutral White 4000K RGBW65 - Cool White 6850K | 01 - BLACK RAL 9011 02 - DARK GREY RAL 7043 03 - WHITE RAL 9003 04 - METALLIC SILVER RAL 9006 05 - MATTE SILVER RAL 9006 06 - LIGMAN BRONZE 07 - CUSTOM RAL | 120/277v Other - Specify |

| | | | |
|---------------------------|--|--|--|
| | | | |
| ADDITIONAL OPTIONS | | | |

- DIM - 0-10v Dimming
- NAT - Natatorium Rated
- WLC - Wireless Lighting Controls
- AMB - Turtle Friendly Amber LED
- HSS - House Side Shield
- F - Frosted Lens
- OS - Occupancy Sensor

Quantum Product Family



- UQA-50001-42w-3634lm
- UQA-50003-32w-2790lm
- UQA-50004-33w RGBW-1432lm



- UQA-50011-104w-10611lm
- UQA-50013-76w-7175lm
- UQA-50015-77w RGBW-4296lm



- UQA-50021-269w-27436lm
- UQA-50022-191w RGBW-12213lm



- UQA-21001-3x42w-3x3634lm
- UQA-21003-3x32w-3x3250lm
- UQA-21004-3x33w RGBW-3x1185lm
- UQA-21011-6x42w-6x3634lm
- UQA-21013-6x32w-6x3250lm
- UQA-21014-6x33w RGBW-6x1185lm



- UQA-21021-104w-10611lm
- UQA-21023-76w-7175lm
- UQA-21024-84w-8031lm
- UQA-21031-2x104w-2x10611lm
- UQA-21033-2x76w-2x7175lm
- UQA-21034-2x84w-2x8031lm



- UQA-21025-77w-4296lm
- UQA-21035-2x77w-2x4296lm