



## 3G-58RMSL

5.8" RECESSED MADISON SLOT  
DYNAMIC WHITE

5.8" recessed slot designed for continuous runs in various configurations  
Suitable for drywall, wood, and other architectural ceiling applications  
Suitable for grid ceiling and 6" techzone applications  
Machined aluminum double gimbals. Adjustable and lockable  
Individual fixture heads can slide within the channel  
Easily adjustable in the field for maximum flexibility  
Dim to Warm and Tunable White LED options up to 2000lm (90+ CRI)  
1% dimming standard with several integral driver options



**3GD** **3GT**

### ORDERING INFORMATION

PROJECT:

TYPE:

CATALOG #:

DATE:

CAT. NO	LED SOURCE	LUMEN OUTPUT	CRI	BEAM ANGLE	VOLTAGE
<b>3G-58RMSL</b>	<b>DW</b> - DIM TO WARM (1800-3000K) <b>TW</b> - TUNABLE WHITE <sup>1</sup> (2700K-6500K)	<b>08</b> - 800 LUMENS <b>12</b> - 1200 LUMENS <b>20</b> - 2000 LUMENS	<b>H90</b> - 90+ CRI	<b>10D</b> - 10° <sup>2</sup> <b>20D</b> - 20° <b>40D</b> - 40° <b>60D</b> - 60° <b>90D</b> - 90° *	<b>UNV</b> - 120/277V <b>120</b> - 120V <b>347</b> - 347V (0-10V ONLY)
				* 90D reflector supplied standard with lens	

DRIVER	FLANGE TYPE	GIMBAL FINISH	HOUSING INTERIOR
<b>DIM</b> - 0-10V (STANDARD 100-1%) <b>LE</b> - PHASE DIMMING <sup>3</sup> (TRIAC/ELV, 100-1%) <b>LTEA</b> - LUTRON HI-LUME LTEA <sup>3</sup> (FWD PHASE, 100-1%) <b>D01</b> - 0-10V (eidoLED, 100-0.1%) <sup>1</sup> <b>DALI</b> - DALI (eidoLED, 100-1%) <sup>1,4</sup> <b>DHL2</b> - LUTRON HI-LUME LDE1 (1% ECOSYSTEM) <b>DMX</b> - DMX (eidoLED, 100-0%) <sup>1</sup>	<b>WT</b> - WHITE TRIM FLANGE <b>XTR</b> - TRIMLESS <b>FX</b> - FLANGELESS <b>GCX</b> - GRID CEILING (UNIVERSAL MOUNT) * <b>6TZ</b> - 6" TECHZONE (AVAILABLE IN STRAIGHT RUNS ONLY)  * Grid ceiling fixtures ship with universal mounting brackets suitable for all ceiling types. See mounting section for details	<b>NG</b> - NATURAL ALUMINUM <b>BG</b> - BLACK <b>WG</b> - WHITE	<b>BK</b> - BLACK (STANDARD) <b>WH</b> - WHITE

OPTIONS	RUN TYPE	FIXTURE HEAD SPACING
<b>CP</b> - CHICAGO PLENUM <b>2C</b> - 2 CIRCUIT <b>3C</b> - 3 CIRCUIT <b>SF70</b> - SOFTENING LENS <b>LS70</b> - LINEAR SPREAD <b>HXB70</b> - BLACK HEXCELL LOUVER <b>EMR</b> - EMERGENCY BATTERY <sup>5</sup> (REMOTE)  Maximum 3 optical accessories. See optical accessories page for more options	<b>S</b> - ____' (STRAIGHT RUN) <b>L</b> - ____'X ____' L-SHAPE) <b>U</b> - ____'X ____'X ____' (U-SHAPE) <b>R</b> - ____'X ____' (RECTANGLE/SQUARE)  U-Shape and R-Rectangle/Square not available with grid ceiling applications. Continuous runs available in 6" increments	<b>12</b> - 12" ON CENTER <b>18</b> - 18" ON CENTER <b>24</b> - 24" ON CENTER <b>36</b> - 36" ON CENTER <b>48</b> - 48" ON CENTER <b>CUS (xx)</b> - CUSTOM SPACING *  * Specify number of fixture heads (XX)

<sup>1</sup> Tunable White option available with D01, DALI and DMX drivers

<sup>2</sup> 10D reflector available with 800 lumen output only

<sup>3</sup> Phase dimming options available in 120V only

<sup>4</sup> DALI-2 (Type 6) provided as standard. Consult factory for DALI Type 8 option

<sup>5</sup> Emergency battery installed remotely by others. Not accessible through the inside of the fixture

**3GD** - Warm Dim

**3GT** - Tunable White

NOVEMBER 3, 2020

### PERFORMANCE CHART BASED ON 20° BEAM AND 3000K SOURCE (PER FIXTURE HEAD)

DIM TO WARM LUMEN OUTPUT	90+ CRI (3000K)		
	DELIVERED LUMENS	SYSTEM WATTS	EFFICACY (LPW)
800LM	N/A	N/A	N/A
1200LM	1136	15.4	74
2000LM	1593	23.2	69

### PHOTOMETRY (PER FIXTURE HEAD)

#### 10D - 10° BEAM ANGLE

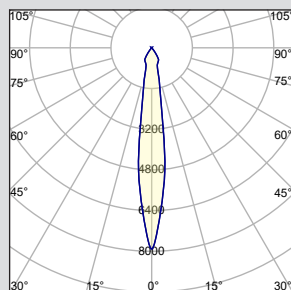

##### 3G-58RMSL-DW-08-H90-10D

LUMEN OUTPUT: 800LMs  
 DELIVERED LUMENS: 759LMs  
 SYSTEM WATTS: 10.3W  
 EFFICACY: 74LPW  
 CRI: 90+  
 CCT: 3000K

#### 60D - 60° BEAM ANGLE

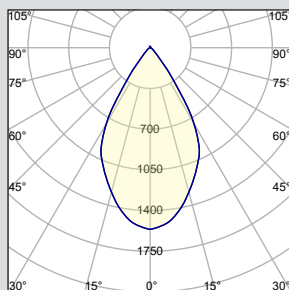

##### 3G-58RMSL-DW-12-H90-60D

LUMEN OUTPUT: 1200LMs  
 DELIVERED LUMENS: 1091LMs  
 SYSTEM WATTS: 15.4W  
 EFFICACY: 71LPW  
 CRI: 90+  
 CCT: 3000K

#### 20D - 20° BEAM ANGLE

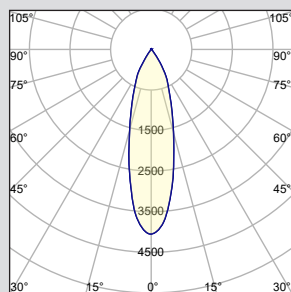

##### 3G-58RMSL-DW-12-H90-20D

LUMEN OUTPUT: 1200LMs  
 DELIVERED LUMENS: 1136LMs  
 SYSTEM WATTS: 15.4W  
 EFFICACY: 74LPW  
 CRI: 90+  
 CCT: 3000K

#### 90D - 90° BEAM ANGLE

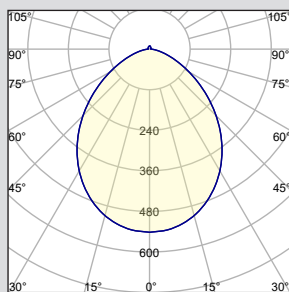

##### 3G-58RMSL-DW-12-H90-90D

LUMEN OUTPUT: 1200LMs  
 DELIVERED LUMENS: 1003LMs  
 SYSTEM WATTS: 15.4W  
 EFFICACY: 65LPW  
 CRI: 90+  
 CCT: 3000K

#### 40D - 40° BEAM ANGLE

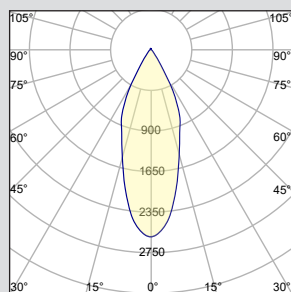

##### 3G-58RMSL-DW-12-H90-40D

LUMEN OUTPUT: 1200LMs  
 DELIVERED LUMENS: 1064LMs  
 SYSTEM WATTS: 15.4W  
 EFFICACY: 69LPW  
 CRI: 90+  
 CCT: 3000K

### PERFORMANCE CHART BASED ON 20° BEAM (PER FIXTURE HEAD)

TUNABLE WHITE LUMEN OUTPUT	90+ CRI (2700K)			90+ CRI (3500K)			90+ CRI (6500K)		
	DELIVERED LUMENS	SYSTEM WATTS	EFFICACY (LPW)	DELIVERED LUMENS	SYSTEM WATTS	EFFICACY (LPW)	DELIVERED LUMENS	SYSTEM WATTS	EFFICACY (LPW)
800LM	N/A	N/A	N/A	N/A	N/A	N/A	N/A	N/A	N/A
1200LM	1066	16.6	64	1091	16.6	66	1221	16.6	74
2000LM	1491	24.5	61	1561	24.5	64	1684	24.5	69

### PHOTOMETRY (PER FIXTURE HEAD)

#### 10D - 10° BEAM ANGLE

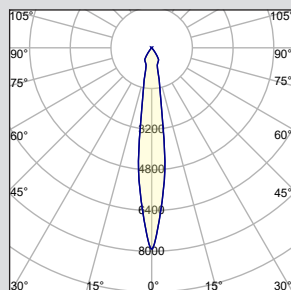

#### 3G-58RMSL-TW-08-H90-10D

LUMEN OUTPUT: 800LMs  
 DELIVERED LUMENS: 789LMs  
 SYSTEM WATTS: 12.6W  
 EFFICACY: 63LPW  
 CRI: 90+  
 CCT: 3500K

#### 60D - 60° BEAM ANGLE

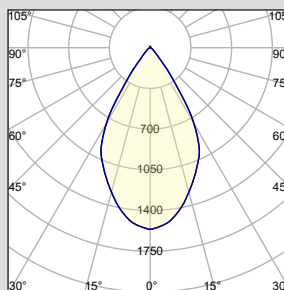

#### 3G-58RMSL-TW-12-H90-60D

LUMEN OUTPUT: 1200LMs  
 DELIVERED LUMENS: 1110LMs  
 SYSTEM WATTS: 24.5W  
 EFFICACY: 67LPW  
 CRI: 90+  
 CCT: 3500K

#### 20D - 20° BEAM ANGLE

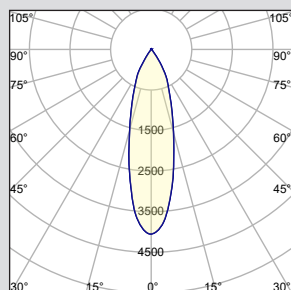

#### 3G-58RMSL-TW-12-H90-20D

LUMEN OUTPUT: 1200LMs  
 DELIVERED LUMENS: 1091LMs  
 SYSTEM WATTS: 24.5W  
 EFFICACY: 66LPW  
 CRI: 90+  
 CCT: 3500K

#### 90D - 90° BEAM ANGLE

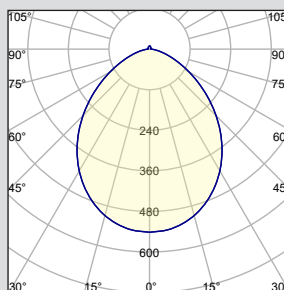

#### 3G-58RMSL-TW-12-H90-90D

LUMEN OUTPUT: 1200LMs  
 DELIVERED LUMENS: 1022LMs  
 SYSTEM WATTS: 24.5W  
 EFFICACY: 62LPW  
 CRI: 90+  
 CCT: 3500K

#### 40D - 40° BEAM ANGLE

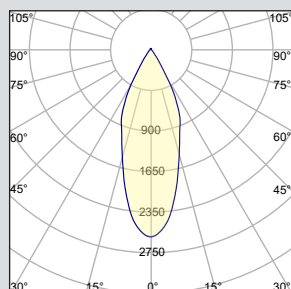

#### 3G-58RMSL-TW-12-H90-40D

LUMEN OUTPUT: 1200LMs  
 DELIVERED LUMENS: 1027LMs  
 SYSTEM WATTS: 24.5W  
 EFFICACY: 62LPW  
 CRI: 90+  
 CCT: 3500K

**TECHNICAL****HOUSING**

Housing constructed in extruded aluminum and cold rolled steel  
Designed for continuous runs in various configurations. Available in 6" increments  
Maximum ceiling thickness of 1.75". Consult factory for modifications  
Standard matte black powder coated finish with optional matte white finish  
Trim flange with matte white powder coated finish and minimal 0.400" overlap  
Trimless model features an extruded aluminum mudding flange for seamless ceiling integration  
Integral aluminum blocking support also provided to ensure fixture is properly secured within ceiling structure

**ADJUSTABILITY**

Solid aluminum, 70mm double gimbals with dual axis adjustability (45°x45°)  
Individual fixture heads can slide left or right within the channel. Easily adjustable in field  
Each double gimbal can be locked in place

**OPTICS**

Regressed LED source for enhanced glare control  
Proprietary anodized, aluminum reflectors are field replaceable (10° reflector not interchangeable)  
Available in 10°, 20°, 40°, 60° and 90°

**ELECTRICAL**

Standard 0-10V, constant current drivers with 100-1% dimming range and >0.9 power factor  
Standard 120/277V universal voltage drivers. Optional 347V, 0-10V driver  
Lutron EcoSystem and eldoLED DALI options available with 100-1% dimming  
eldoLED 0-10V, 100-0.01% dimming range available (D01)  
DMX drivers available with 100-0% dimming range  
120V Forward Phase/Reverse Phase driver option with 100-1% dimming  
Individual fixture sections can be wired independently  
All drivers are integral and easily accessible through the channel aperture  
Remote emergency battery operates for 90 minutes at 10W (not accessible within channel)

**LED SYSTEM**

Bridgelux LED module (field replaceable)  
Color consistency <3 SDCM  
Standard 90+ CRI  
Dim to Warm (1800K-3000K)  
Tunable White (2700K-6500K)  
L70 >50,000 hours  
5 Year Warranty

**MOUNTING**

New construction housing suspended via 1/4" threaded rod or suspension cables (by others)  
Trim fixture designed for use in drywall, wood, and other architectural ceiling materials  
Trimless fixture designed for use in drywall, mud-in ceiling applications  
Flangeless fixture designed for use in wood ceilings  
Suitable for various grid ceiling applications (see mounting details)

**LISTING**

ETL listed and tested to cUL standards. Suitable for dry and damp locations

**WARRANTY**

5 Year Warranty on LED and drivers  
Manufacturer 1 Year Warranty for defects in material and workmanship under normal use  
Ambient temperature at fixture should not exceed 25°C

**DRAWINGS AND DIMENSIONS** HARD CEILING

**WT - TRIM**

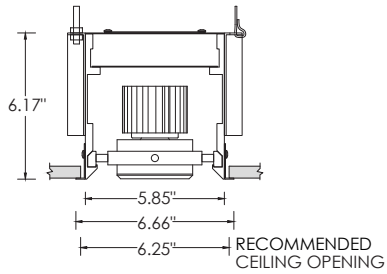

**XTR - TRIMLESS**

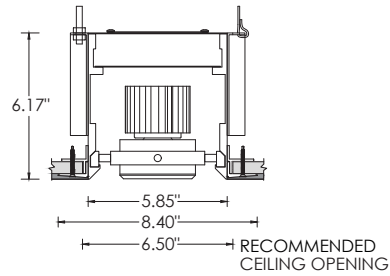

**FX - FLANGELESS**

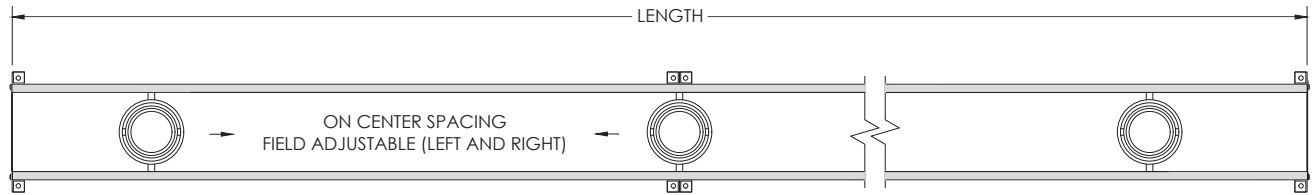
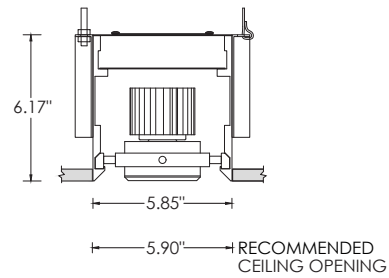

**MOUNTING DETAILS** HARD CEILING

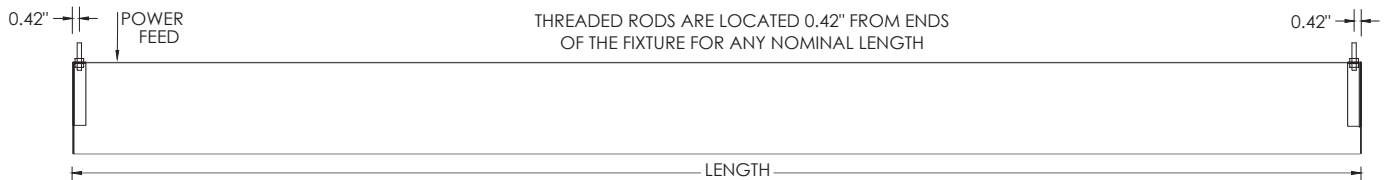

### DRAWINGS AND DIMENSIONS GRID CEILING

**9L - 9/16" LAYIN**

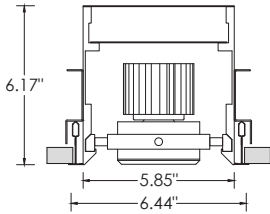

**9TG - 9/16" TEGULAR**

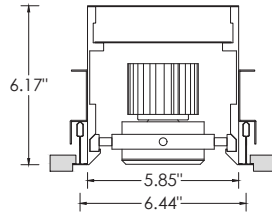

**15L - 15/16" LAYIN**

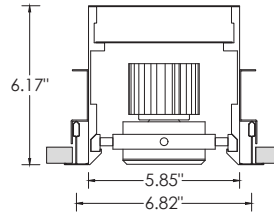

**15TG - 15/16" TEGULAR**

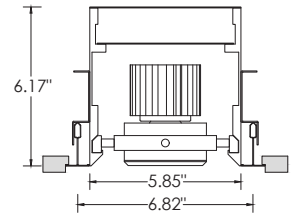

**9ST - 9/16" SLOT TEE TEGULAR**

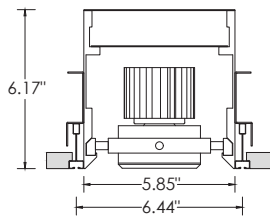

**6TZ - TECHZONE**

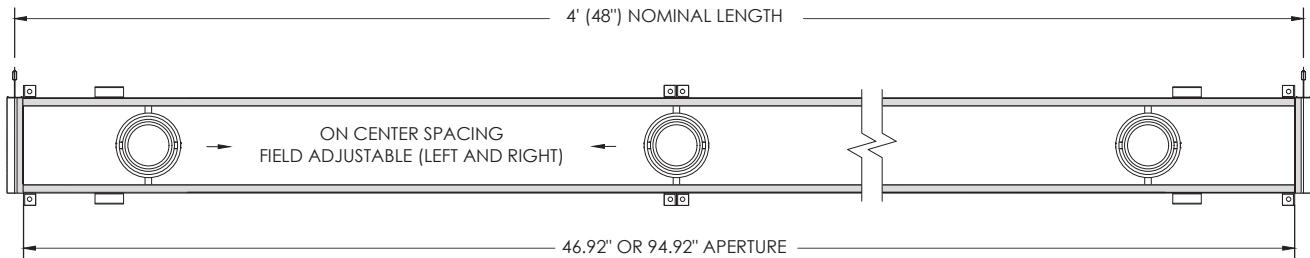
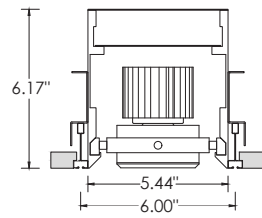

### MOUNTING DETAILS GRID CEILING

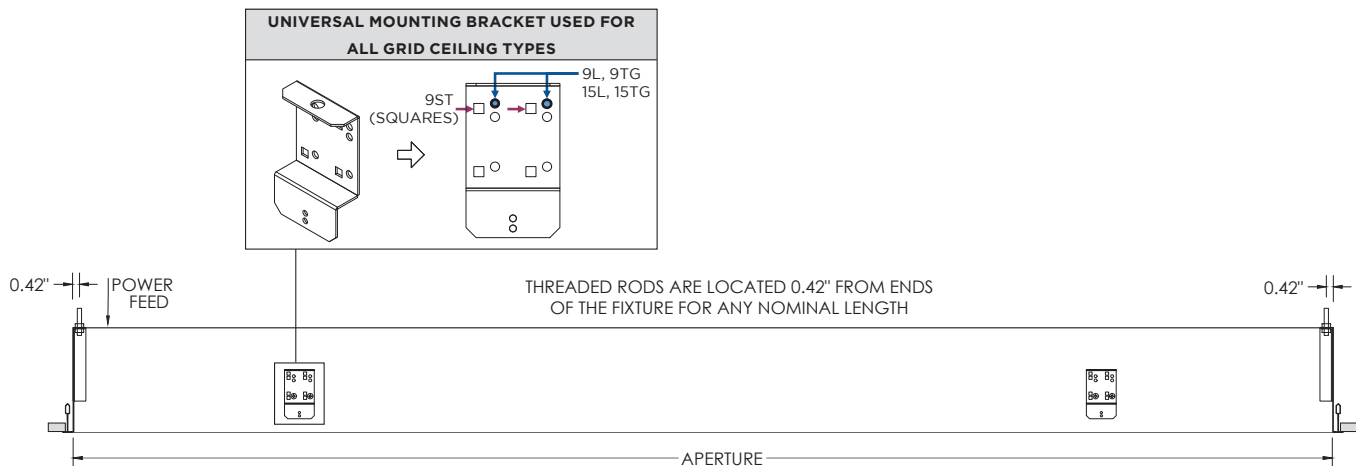

#### GIMBAL ADJUSTABILITY

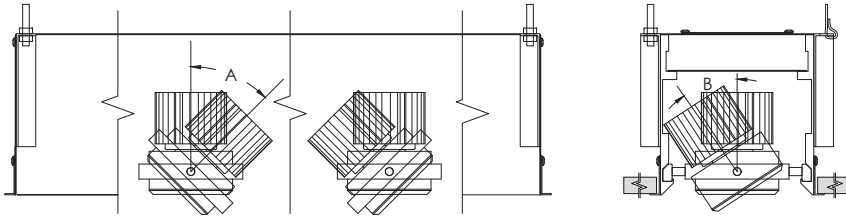

LUMEN OUTPUT	A	B
Up to 2200lm	45°	45°
3000lm/4000lm	45°	35°
5000lm	45°	20°

#### PATTERNS

Specify pattern shape and overall dimensions as shown below  
 Patterns are connected with 12"x12" mitered corner sections (Fixture heads not available)  
 Please consult factory for custom patterns and shapes not shown below

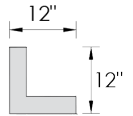

L-SHAPE	U-SHAPE	RECTANGLE/SQUARE
Provide dimensions of AxB Example: <b>L</b> - 5'x6' 	Provide dimensions of AxBxC Example: <b>U</b> - 5'x6'x4' 	Provide dimensions of AxB Example: <b>R</b> - 5'x6' 