

# MRI Lighting Solar Series LED



Amico

## Solar MRI Series

Amico has partnered with industry experts to provide MRI lighting solutions that create a patient experience like no other. Our Enhanced Patient Experience products will transform your MRI Suite into an environment that facilitates healing and relaxation. Request a custom design project or choose from our selection of MRI lighting solutions to create your own personalized MRI Suite. Amico can work with you to simplify the design and installation process, addressing the needs of the designers, contractors and end users.



MRI Cove Lighting • LED Lightbulb  
Downlights • Image Ceiling Panels  
LED Illuminated Image Wall Fixtures



All of Amico's MRI lighting solutions are certified to meet MRI vendor EMI requirements. MRI applications require EMI free emissions for specific frequency bands. All outputs are linear DC and no pulse width modulation (PWM\*).



SIGNA  
Architect



866 mm 00:00



# The Enhanced Patient Experience (EPE)

Amico's MRI lighting solutions are designed to provide an Enhanced Patient Experience. Our lineup of MRI lighting products addresses the common challenges experienced by patients and clinicians in the MRI environment.

## **Did you know?**

- 42% of patients experience fear and anxiety over their scans
- 13% have intense anxiety
- 6% of patients require sedation or anesthesia

Amico uses our EPE products to optimize the MRI environment to create a relaxing, stress-free experience for the patient to help ease their anxieties and reduce their fears associated with their scan. Our suites are designed to reduce claustrophobia and sedation rates while improving the patient experience and clinical workflow.

Amico's Enhanced Patient Experience products provide a positive visual distraction for the patient, allowing them to refocus their attention on their external environment. We use the healing power of nature to restore a sense of peace and calm. Our solutions provide a personalized experience for each patient and allows them more control over their environment. Customers installing this solution have seen improved patient satisfaction, less need for sedation, fewer failed scans, less movement during exams, increased HCAHPS score, competitive advantages in local markets, and increased Technologist satisfaction.



## Featured in this Suite:

### 1 60" 4K Ceiling Video Display

MRI-safe 4K Ceiling and Wall Video Displays bring the healing quality of nature or a favorite movie to patients with a tap of a finger. Additional video and music options with compatible music, DVD and goggle devices available.

### 2 32" HD Portable Video Display for MRI In-bore Viewing

Portable Video Display allows for in-bore viewing with prism glasses, head coil mirrors and mirror bridges. Available in roll stand, wall, or ceiling mount options.

### 3 Illuminated Wall Fixtures

Illuminated Wall Fixtures bring additional light and warmth to the MR Suite and features custom imagery to provide patients with a touch of nature.

### 4 Curved Coves

Curved Cove lighting can be used to illuminate the MR Suite with the patient's favorite color.

### 5 LP6 Low Profile 6" LED Downlight

Our MRI compatible low-profile downlight provides general room lighting within the MR Suite and guarantees zero imaging artifacts.

## Behind the Scenes:

### 6 Caring MR Suite App for One-touch Controls

Deliver every patient's best MRI experience with a tap of a finger. The Caring MR Suite App puts all of the features of the Enhanced Patient Experience Suite at your fingertips. New features include tech favorite customizable Scrolling Text, Gradient Lighting, Countdown Timers, etc.

### 7 RF Shielding

PDC's Lightweight and flexible RF Shielding provides superior attenuation, long-term performance, design flexibility and rapid installation.

## Amico's MRI Lighting Solutions

Amico has partnered with industry leader PDC Facilities (PDC) to provide a complete portfolio of proven medical lighting, 4K ceiling video display, one-touch controls and RF shielding in a single-source solution.

This partnership offers our customers an entire portfolio of proven MRI products all in a single-source solution that simplifies the design and installation process.

Together Amico and PDC can provide you with everything you need to create a fully immersive and personalized MRI experience for your patients without the headache.

Our solutions are designed to meet the most demanding MRI lighting, productivity, and imaging integrity requirements with a guarantee of zero imaging artifacts. Utilize our team of designers to help customize and design an MRI suite that is unique to you.



5

1

4

3

2



## Illuminated Image Ceiling Panel

Transform your windowless space into a calming, patient-centric environment. Amico's 2x2 and 2x4 Illuminated Image Ceiling Panels help patients relax by creating a sense of openness that eliminates claustrophobic fears of being in a confined space. Our image ceiling panels light up any space with your choice of nature or custom images.

Engineered in three components, Amico's Illuminated Image Ceiling Panels come with your customizable graphic art panel, the riser kit, and a white backlit LED. The versatile design of our Illuminated Image Ceiling Panels allows it to be installed in multiple configurations to fit any design requirements. Custom designs and fits are also available through Amico Lights.

### Standard Grid Layouts

Layout	Size	No. of Fixtures
A	2' x 2'	1
B	2' x 4'	2
C	4' x 4'	4
D	4' x 6'	6
E	6' x 6'	9
F	6' x 8'	12
G	8' x 8'	16

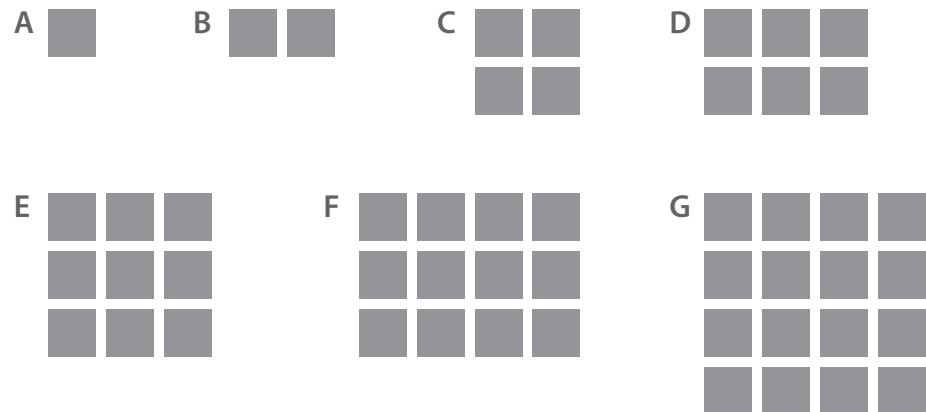





00:00

Patient Name	
Patient ID	DCR
Exam	
Patient Weight	150
Examiner	
Landmark	



## Nature 270

Deliver a fully immersive experience with the Nature 270 floor to ceiling image design. The Nature 270 creates a sense of openness with a calming nature experience from the moment you walk in the door. The healing power of nature and sense of openness allows patients the opportunity to relax fully and eases claustrophobic fears of being in confined spaces. Brighten up any room with your choice of nature imagery, warm white LEDs, or your patient's favorite color. Our Nature 270 products create a serene and comforting atmosphere that elevates the patient, family, and staff experience.

Choose your favorite image from our stock gallery or provide a custom image design. Amico makes it easy for you to personalize your MRI experience. Work with our industry experts to create an MRI environment that is unique to you.



HITACHI

OASIS



MRI LED Illuminated Image Wall Fixtures

## Illuminated Image Wall Fixtures

Amico's Illuminated Image Wall Fixtures are recessed and come in various sizes and depths to meet your lighting requirements. Choose from our standard image gallery or use a custom design or image.

Incorporate Warm White and RGB color-changing accent light to bring additional light and warmth to your MRI Suite.

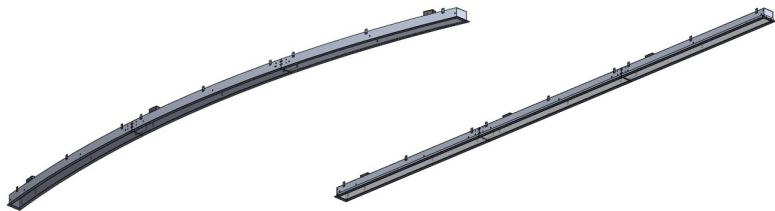

MRI Cove Lighting

## Accent Cove Lighting

Amico's accent Cove Lighting comes in a linear and curved option and can be installed in drywall or acoustic ceilings. Our accent cove lighting contains no onboard electronics and, therefore, will not interfere with MRI imaging.



## Customize your MRI Suite

Amico offers customizable options in all of our Accent lighting and Illuminated Image ceiling panels.

Choose custom images, shapes, lengths, and design layouts that make your space stand out. Our team of industry experts will provide you with the best construction solutions to complete your next project. We work with you to create and design a personalized MRI suite for the Enhanced Patient Experience you deserve.



HITACHI  
OVAL

# MRI Downlights



Our **Low Profile Directional (LPD) LED Downlight** is a game-changer in the MRI environment. The LPD Downlight provides targeted lighting to the MRI bore for procedures on the MRI table, allowing clinicians to work more efficiently and improve clinical workflow.

**CTT:** 3500K, 4000K

**Lumen Output:** 1350 -1650 lm



The **LP6 Low Profile Recessed 6" LED Downlighting** is designed for the MRI room. This low-profile downlight measures less than 3" in depth. It comes equipped with either DC or Ethernet Wiring, allowing for easy and versatile installation.

**CTT:** 3500K, 4000K

**Lumen Output:** 1400 - 1800 lm



The **DL6 Recessed 6" LED Downlight** is designed for MRI suite applications. This low-profile, recessed application measures 3.9" in depth and comes equipped with either DC or Ethernet Wiring.

**CTT:** 3000K, 3500K, 4000K

**Lumen Output:** 2900 lm



The **A21 Retrofit LED Lamp** is the perfect solution if you are looking to replace outdated incandescent MRI lamps with long-lasting LEDs. These lamps provide a consistent and balanced light source with exceptional color stability.

**CTT:** 3500K, 4000K

**Lumen Output:** 1800 – 1980 lm







Increased Productivity



Patient Satisfaction



Improved Workflow  
Leads to More Scans and  
More Appointments



Happier Patients & Staff

# Enhanced Patient Experience Suites – Case Study

## Healthcare Organization:

A study was conducted by a Top-10 Non-Profit Health System with over 500 care sites to determine the “Payback Period” of an Enhanced Patient Experience Suite. This organization has nine (9) Amico Enhanced Patient Experience Suites.

## Objective:

Compare the financial performance of an MR Suite without an Enhanced Patient Experience Suite to a suite installed with an Enhanced Patient Experience Suite. The goal was (1) to determine whether there is a financial benefit associated with an Enhanced Patient Experience Suite and (2) if there is a financial benefit, what is the ROI period.

## Customer’s MR Suite:

The Enhanced Patient Experience Suite and RF Shielding were provided by Amico and PDC Facilities.

## Study Duration:

Twelve-month analysis comparing the financial performance of the MR with an Amico Enhanced Patient Experience Suites to their MR Systems without the Enhanced Patient Experience Suite.

## Results:

- **Anesthesia:**
  - Outpatient anesthesia is 56.9% lower in the MR with the Enhanced Patient Experience Suite
  - Hospital-based Inpatient anesthesia dropped from 9.5% of patients in MR suites without an Enhanced Patient Experience Suite to 2.4% of patients in the MR with the Enhanced Patient Experience Suite
- **Escape Rate / Patient Terminations:** were 85% lower in the MR with the Enhanced Patient Experience Suite
- **Revenue from increased scans:** revenue was \$825,000 higher in the Enhanced Patient Experience Suite
- **Net Income:** was \$260,000 higher in the Enhanced Patient Experience Suite
- **Payback Period attributable to Enhanced Patient Experience Suite:** 6.7 months - payback was calculated using net income rather than cash flow

## \*Increased Revenue was Determined to Accrue from:

- Improved workflow, more scans were completed on schedule, more appointments
- Reduced anxiety, re-scans, patient stops and escapes improved productivity
- Fewer anesthesia patients, increased scans per day, and reduced expenses
- Increased patient satisfaction leads to referrals with patients travelling from up to 100 miles away
- Happy patients lead to happy relaxed MRI Technicians and staff, leading to increased productivity



## The suite featured in the study included:

60" 4K Ceiling Video Display

32" HD Portable Video Display for MRI in-bore viewing

Illuminated Wall Fixtures and Curved Cove Lights

DL6 Recessed Downlights and LDP Directional Downlights

Patient-personalized Nature Theme video or DVD, lighting and music

Caring MR Suite App for one-touch controls

PDC Shielding



Amico Lights Corporation  
122-B East Beaver Creek Road, Richmond Hill, ON L4B 1G6, Canada  
Toll Free Phone: 1.877.462.6426 | Toll Free Fax: 1.866.440.4986  
Tel: 905.764.0800 | Fax: 905.764.0862  
Email: [info@amico.com](mailto:info@amico.com) | [www.amico.com](http://www.amico.com)



Visit [amico.com](http://amico.com) for more information  
about our MRI Series of lights

in collaboration with:  
**PDC**