

UQA-21004

Quantum 1 Single Side RGBW Cluster Column



3x33w LED
3x1185 Lumens

IP66
Suitable for wet locations

IK08
Impact Resistant [Vandal Resistant]

Weight 82.8 lbs

POLE NOT INCLUDED

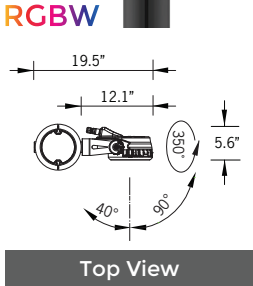

Top View

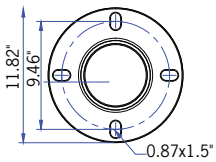
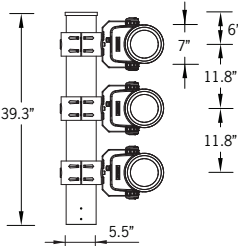

Mounting Detail

Construction

Aluminum

Less than 0.1% copper content – Marine Grade 6060 extruded & LM6 Aluminum High Pressure die casting provides excellent mechanical strength, clean detailed product lines and excellent heat dissipation.

Pre paint

8 step degrease and phosphate process that includes deoxidizing and etching as well as a zinc and nickel phosphate process before product painting.

Memory Retentive -Silicon Gasket

Provided with special injection molded “fit for purpose” long life high temperature memory retentive silicon gaskets. Maintains the gaskets exact profile and seal over years of use and compression.

Thermal management

LM6 Aluminum is used for its excellent mechanical strength and thermal dissipation properties in low and high ambient temperatures. The superior thermal heat sink design by Ligman used in conjunction with the driver, controls thermals below critical temperature range to ensure maximum luminous flux output, as well as providing long LED service life and ensuring less than 10% lumen depreciation at 50,000 hours.

Surge Suppression

Standard 10kv surge suppressor provided with all fixtures.

BUG Rating

B3 - U0 - G0

Finishing

All Ligman products go through an extensive finishing process that includes fettling to improve paint adherence.

Paint

UV Stabilized 4.9Mil thick powder coat paint and baked at 200 Deg C. This process ensures that Ligman products can withstand harsh environments. Rated for use in natatoriums.

Hardware

Provided Hardware is Marine grade 316 Stainless steel.

Anti Seize Screw Holes

Tapped holes are infused with a special anti seize compound designed to prevent seizure of threaded connections, due to electrolysis from heat, corrosive atmospheres and moisture.

Crystal Clear Low Iron Glass Lens

Provided with tempered, impact resistant crystal clear low iron glass ensuring no green glass tinge.

Optics & LED

Precise optic design provides exceptional light control and precise distribution of light. LED CRI > 80

Lumen - Maintenance Life

L80 /B10 at 50,000 hours (This means that at least 90% of the LED still achieve 80% of their original flux)

Adjustable column technical projector cluster solution. Flexible technical project solutions in attractive cluster arrangements using the Stylish premium Quantum projectors.

Quantum small size LED cluster projectors on light column. The high pressure die-cast housings have integrated heat sinks, as well as a internal waterproof control gear housing compartment. The mounting arm is attached to a ratcheting tilting adjustment that is lockable once the desired aiming position has been achieved. The floodlights can be aimed in different directions to highlight specific features or elements in the environment, as well as provide security when illuminating dark areas on campuses and parks. The luminaires are available with RGBW or static white light.

This fixture has been designed around powerful high performance LEDs and precision optics so that the luminaire can be used to illuminate various applications like parks and recreational areas, building facades, high multi-story surfaces and accents. The luminaire is provided with an integral driver and is available in Narrow, Medium, Wide and Elliptical light distributions. RGBW full color LED integration and static white with color temperatures of 2700K, 3000K, 3500K and 4000K. Cable gland entries on luminaire. Stainless steel fasteners in grade 316.

Optional louvers or visors are available upon request. Consult factory for available configurations. As a standard product this is offered in a 3 or 6 fixture configuration, however the fixture quantities, positions, watts & beam spread can be manufactured to suit designer's specifications. The Quantum Cluster adds to Ligman's comprehensive range of event pole cluster luminaires with different floodlight shapes, styles and wattages.

Additional Options (Consult Factory For Pricing)



ACL
Anti Glare Louvre

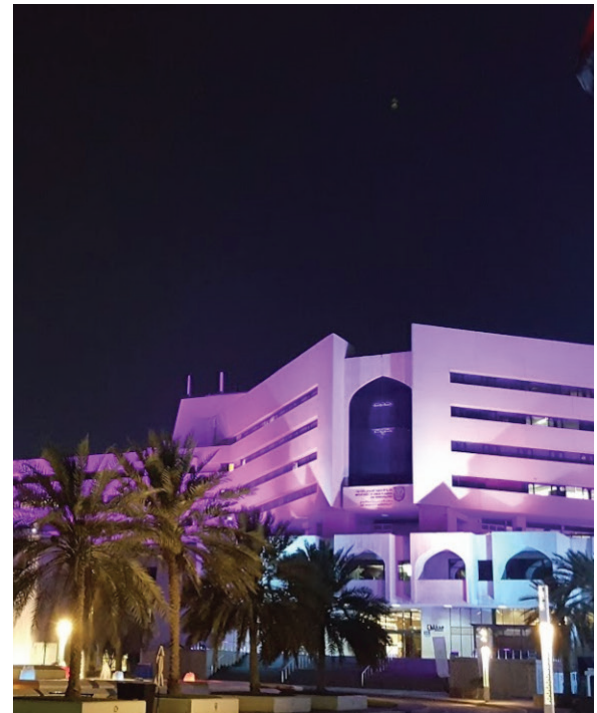

UQA-21004

Quantum 1 Single Side RGBW Cluster Column



PROJECT		DATE	
----------------	--	-------------	--

QUANTITY		TYPE		NOTE	
-----------------	--	-------------	--	-------------	--

ORDERING EXAMPLE || UQA - 21004 - 3x33w LED - N - W30 - 02 - 120/277v

UQA-21004					
LAMP	BEAM	RGBW COLOR	FINISH COLOR	VOLTAGE	
3x33w LED 3x1185 Lumens	N - Narrow 21° M - Medium 35° E - Elliptical 26° x 48°	RGBW30 - Warm White 3200K RGBW40 - Neutral White 4000K RGBW65 - Cool White 6850K	01 - BLACK RAL 9011 02 - DARK GREY RAL 7043 03 - WHITE RAL 9003 04 - METALLIC SILVER RAL 9006 05 - MATTE SILVER RAL 9006 06 - LIGMAN BRONZE 07 - CUSTOM RAL	120/277v Other - Specify	



--	--	--	--

ADDITIONAL OPTIONS

- DIM - 0-10v Dimming
- NAT - Natatorium Rated
- GFCI - GFCI Box
- AGL - Anti Glare Louvre



Quantum Product Family



- UQA-50001-42w-3634lm
- UQA-50003-32w-2790lm
- UQA-50004-33w RGBW-1432lm



- UQA-50011-104w-10611lm
- UQA-50013-76w-7175lm
- UQA-50015-77w RGBW-4296lm



- UQA-50021-269w-27436lm
- UQA-50022-191w RGBW-12213lm



- UQA-21001-3x42w-3x3634lm
- UQA-21003-3x32w-3x3250lm
- UQA-21004-3x33w RGBW-3x1185lm
- UQA-21011-6x42w-6x3634lm
- UQA-21013-6x32w-6x3250lm
- UQA-21014-6x33w RGBW-6x1185lm



- UQA-21021-104w-10611lm
- UQA-21023-76w-7175lm
- UQA-21024-84w-8031lm
- UQA-21031-2x104w-2x10611lm
- UQA-21033-2x76w-2x7175lm
- UQA-21034-2x84w-2x8031lm



- UQA-21025-77w-4296lm
- UQA-21035-2x77w-2x4296lm