

Type:

Job:

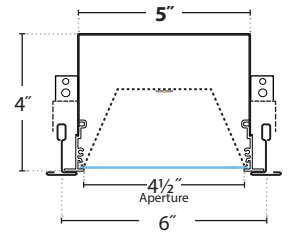

Technical Questions



[CLICK HERE](#)

**What distinguishes BionicPro?** 2" - 3" - 4" - 5" luminaires with a seamless lens for clean lines of light and no light leaks, anywhere. Fantastic optical performance via our TruBeam™ technology delivering the industry's best batwing with remarkably soft, even illumination and low glare (UGR <19), a vastly improved Ceiling Wash, two wall washes to fit your design intent, our Perimeter Fill to wash corridors with light from one side, all with just a lens change.

**BPRO5-REC-FLSH-LED35-MO-BTW**  
 2975 Delivered Lumens  
 23 Watts  
 131 lm/w  
 1.94 Spacing Criteria

UP TO **131** LM/W

	LO	MO	SO	HO
<b>BTW</b> Lm/Ft	500	740	1025	1300
<b>SAL</b> Lm/Ft	485	715	990	1245
<b>WWF</b> Lm/Ft	500	750	1025	1325
<b>WWG</b> Lm/Ft	500	750	1025	1300
W/Ft	4	6	8	10.5

LUMEN CHART AT 3500K-80 CRI

Designed to fit Armstrong's TechZone6.

TechZone6



Lumen output may vary +/- 5%  
 Light Loss Factor (LLF) for CCTs other than 3500K:  
 4000K +2%, 3000K -5%, 2700K -20%  
 90 CRI -15% (3K, 3500K, 4K & 5K)  
[See LED Details PDF for more info](#)

SE-RIES	LENS POSITION	LED COLOR	OUTPUT	NOM. LGTH	TRIM COLOR	DISTRIBU-TION	MOUNT-ING	CIRCU-ITING	VOLTAGE	CEILING SYSTEMS	DRIVERS	OPTIONS & CONTROL SENSORS
BPro5-REC	FLSH							SC				
Bion-icPro5	FLSH Flush Lens	CH Chroma-Hue, RGBW	LO Low MO Medium SO Standard HO High PROG Programmable Light Output (Specify desired lm/ft or w/ft)	2' 3' 4' 5' 6' 7' 8' R (Row Length, 1/8" increments)	TMW Textured Matte White (Standard) YGW Gloss White Y_ Premium Color CC Custom Color	SAL Satin Lens BTW Batwing WWF Flat Wall Wash WWG Focal Glow Wall Wash	LP Light Pocket WTW Wall to Wall (See page 4 for details)	SC Single Circuit	UNV (120-277) 120 277 347 (Emergency battery requires a Step Down transformer and remote box)	X1 1 1/16" T-Bar X1M 9/16" T-Bar X1T 1 1/16" T-Bar Tegular X2 Dimensional T-Bar Armstrong Inter-lude® X3 Hard Ceiling (Flange Trim) X6 Slot Grid X7 Mud-Over Flange X9 Finished Extruded Side (Wood, metal pan or other ceiling systems)	EPDA EldoLED PowerDrive RGBW, DMX	EMHE Emergency Battery (1250 Delivered lumens, CA Title 20 compliant; 4' or longer) ETS-DR Iota ETS-DR Emergency Transfer Switch EMC Emergency Circuiting CP Chicago Plenum OMB Overhead Mounting Bracket (X3, X7 and X9 optional installation - 2x per fixture)  <b>SENSORS:</b> 205 WattStopper PIR 205-ON/OFF 205-STEP: Dim to 50% 205-DM: Dim to 1% ENL Enlighted SU-5E-IOT  LVOC Lutron Vive (Occ & RF) LVRF Lutron Vive (RF Only) NXSMP Hubbell (Occ) NLT Acuity N-Light  <b>CORNERS:</b> C2-60 Lit 60° C4X Lit 45°-135° C2-120 Lit 120° C2-135 Lit 135° C3T Lit 90° C3T Lit 90° C3Y Lit 120° C4T Lit 90° C4X Lit 45°-135° C8I Lit 90° C8I Lit 90° C3Y Lit 120° C8O Lit 90° C8O Lit 90°  LRT Linear to Recessed Transition



**DISTRIBUTIONS:**

**SATIN LENS**

**Medium Output:**

**BPRO5-REC-FLSH-LED35-MO-SAL**

2872 Delivered Lumens  
23 Watts  
126 lm/w  
1.24 Spacing Criteria  
Test #104013131LAX-001F

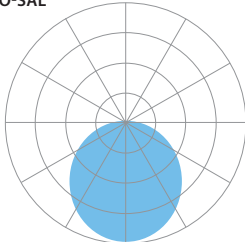

**Zonal Lumen Summary:**  
0-90 = 100%

**1033**

Vertical Angle	0°	25°	45°	65°	90°
0°	1033	1033	1033	1033	1033
5°	1024	1025	1022	1027	1028
15°	974	976	977	984	987
25°	884	887	891	903	909
35°	768	771	777	792	800
45°	634	635	642	656	668
55°	486	487	494	507	520
65°	332	332	340	351	363
75°	173	175	186	196	207
85°	27	28	35	47	57
90°	0	0	0	0	0

**FLAT WALL WASH**

**Standard Output:**

**BPRO4-LIN-FLSH-LED35-SO-4-WWF**

2056 Delivered Lumens  
15 Watts  
136 lm/w  
3500 CCT  
Test 104359650LAX-005B

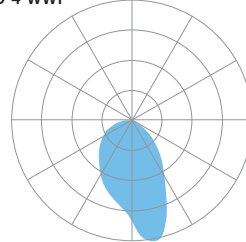

**Zonal Lumen Summary:**  
0-90 = 100%

**1340**

Vertical Angle	0°	25°	45°	65°	90°
90°	0	0	0	0	0
85°	26	29	30	30	28
75°	85	87	100	102	94
65°	148	157	196	212	185
55°	243	267	343	413	339
45°	416	461	577	686	513
35°	698	744	873	941	634
25°	1032	1082	1189	1046	711
15°	1340	1322	1205	971	764
5°	975	955	908	850	792
0°	794	794	794	794	794
5°	697	702	715	748	792
15°	623	626	634	668	764
25°	553	557	568	596	711
35°	472	477	490	516	634
45°	358	365	388	412	513
55°	248	249	264	282	339
65°	172	162	161	163	185
75°	112	98	120	84	94
85°	33	29	24	25	28
90°	0	0	0	0	0
Vertical Angle	180°	202.5°	225°	247.5°	270°

WALL SIDE

ROOM SIDE

**FOCAL GLOW WALL WASH**

**Low Output:**

**BPRO5-FLSH-LED35-LO-4-WWG**

2042 Delivered Lumens  
15 Watts  
135 lm/w  
3500 CCT  
Test 104464711LAX-011

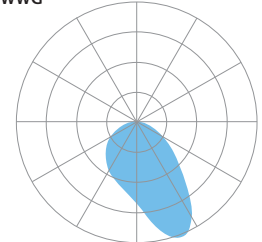

**Zonal Lumen Summary:**  
0-90 = 100%

**1256**

Vertical Angle	0°	25°	45°	65°	90°
90°	0	0	0	0	0
85°	27	27	30	32	31
75°	79	83	104	111	97
65°	151	163	225	232	167
55°	281	310	450	440	259
45°	550	613	811	662	373
35°	1042	1087	1078	764	491
25°	1256	1209	1024	798	607
15°	1019	993	906	808	698
5°	835	833	808	782	747
0°	754	754	754	754	754
5°	658	668	682	712	747
15°	520	528	550	605	698
25°	450	456	466	499	607
35°	397	397	402	414	491
45°	349	344	335	333	373
55°	294	285	261	243	259
65°	232	217	184	160	167
75°	154	141	107	93	97
85°	57	55	36	30	31
90°	0	0	0	0	0
Vertical Angle	180°	202.5°	225°	247.5°	270°

WALL SIDE

ROOM SIDE

**BATWING**

**Medium Output:**

**BPRO5-REC-FLSH-LED35-MO-BTW**

2975 Delivered Lumens  
23 Watts  
131 lm/w  
1.94 Spacing Criteria  
Test #104013131LAX-001C

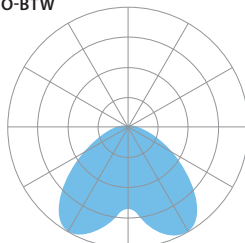

**Zonal Lumen Summary:**  
0-90 = 100%

**716**

Vertical Angle	0°	25°	45°	65°	90°
0°	716	716	716	716	716
5°	774	768	744	725	709
15°	1008	972	861	731	655
25°	1143	1104	953	710	568
35°	1120	1092	955	651	475
45°	944	941	854	553	394
55°	637	661	654	429	321
65°	360	380	405	300	248
75°	170	179	199	176	162
85°	33	34	42	52	57
90°	0	0	0	0	0



## LUMEN MAINTENANCE

- L70** — 200,000+ Hours
- L90** — 100,000+ Hours (LO, MO & SO)
- L90** — 60,000+ Hours (HO)

**LED SYSTEM** LED modules and drivers are field replaceable.

**PROG**  
(OPTIONAL) Programmable light output. Specify desired lumens or watts per linear foot.

**BINNING** Standard binning (all Prudential LED boards) includes testing at the chip level and board integration to provide consistent color temperature within a 3-step MacAdams ellipse, with +/- 5% lumen output range and +/- .004 Duv.

**LABELS** ETL damp labeled and I.B.E.W. manufactured.

**ELECTRICAL** Must specify LED dimming controls. LED fixtures have constant current driver(s) with less than 20% THD when loaded to a minimum of 60%. Drivers sink a maximum of 6mA per driver. DM01 LED drivers are 0-10V dimmable and are compatible with most 0-10V wall slide dimmers and direct 0-10V analog signal dimmers. Max driver size 1.65" w x 1.25" h.

## CONSTRUCTION

- Housing** Extruded aluminum trim and side wall >25% PC recycled, 100% recyclable.  
20-gauge steel top housing >20% PC recycled, 100% recyclable.
- Lens** Acrylic, 100% recyclable.
- Weight** 4.5 lbs / ft.

**MOUNTING** Recessed into drywall or t-bar ceilings.

**WARRANTY** Single-source, 5 year limited warranty covers standard components and construction.



YSW – Seashell White (Matte)	YCH – Champagne (Metallic)
YSL – Silver (Metallic)	YPE – Pewter (Matte)
YRG – Rain Grey (Gloss)	YSTM – Storm Grey (Matte)
YBK – Black (Matte)	YBB – Black (Semi Gloss)
YSKM – Sky (Matte)	YMB – Military Blue (Matte)
YIB – Interstate Blue (Matte)	YSAM – Sapphire (Matte)
YFGM – Forest Green (Matte)	YBR – Bronze (Matte)
YBY – Boysenberry (Matte)	YSRM – Sunset Red (Matte)
YOR – Orange (Matte)	YDAM – Daffodil (Matte)



ADJOINING DETAILS

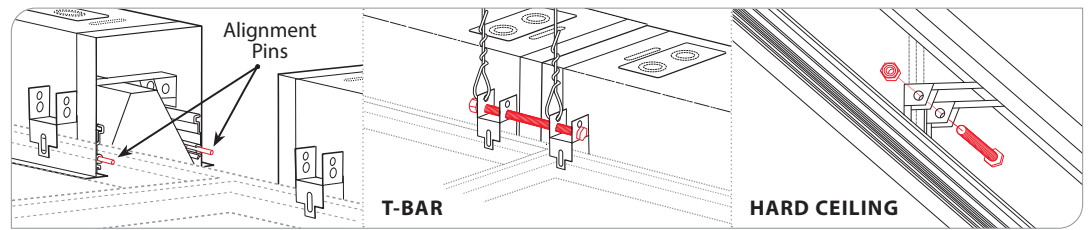

Choose from one of our Premium Colors with no set-up fee.

For paint chip samples, please email: [info@prulite.com](mailto:info@prulite.com)

CEILING SYSTEMS

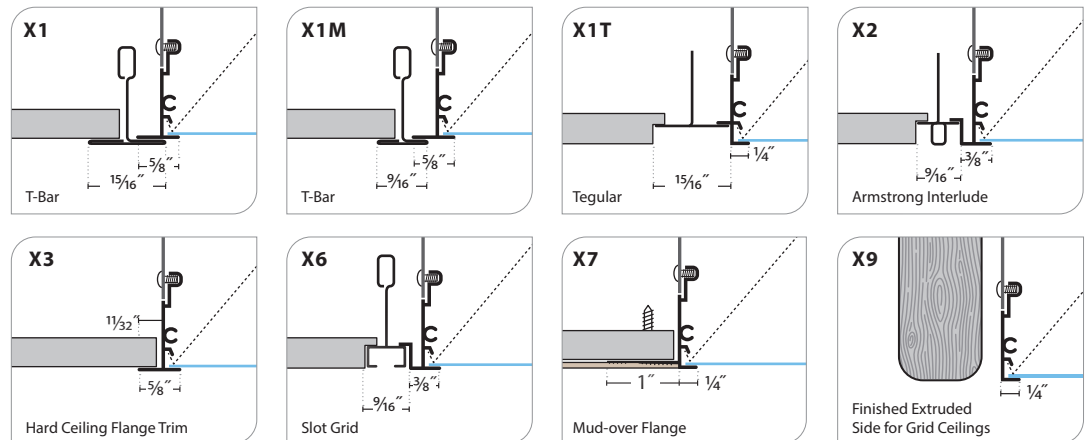

CAST ALUMINUM END CAPS

OVERHEAD MOUNTING BRACKETS (OMB)

X9 MOUNTING

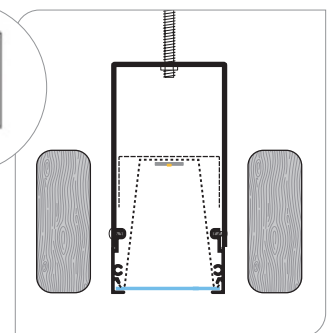
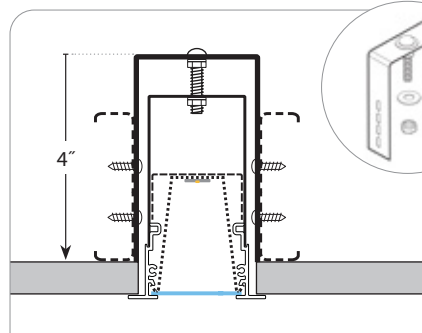
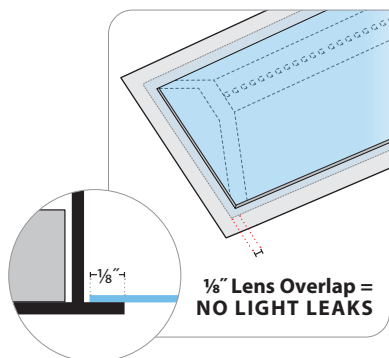



## Corners

**C2-60:**

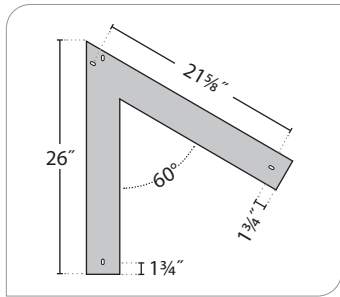

**C2-90:**

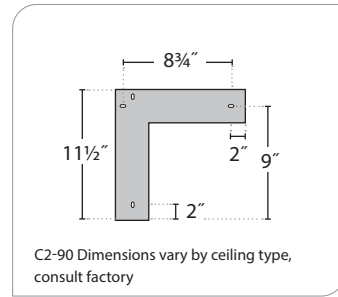

**C2-120:**

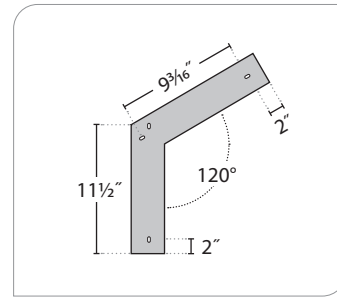

**C2-135:**

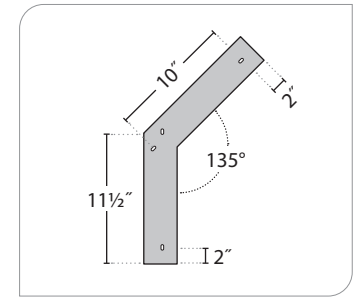

**C3T:**

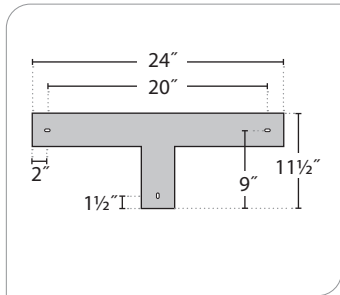

**C3Y:**

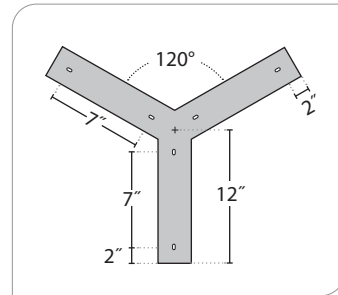

**C4T:**

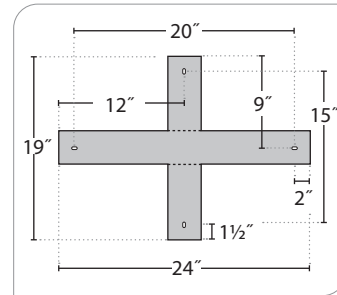

**C4X:**

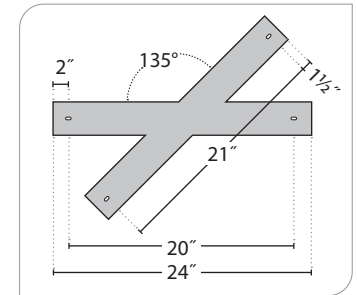

**C8I:**

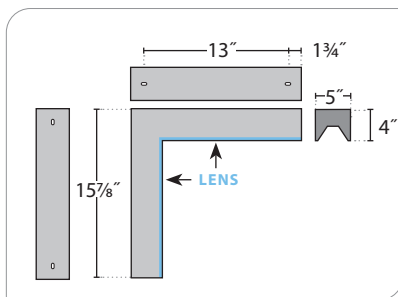

**C8O:**

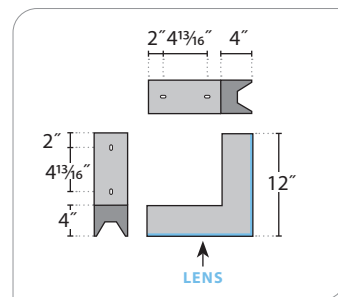

## MOUNTING

### LIGHT POCKET

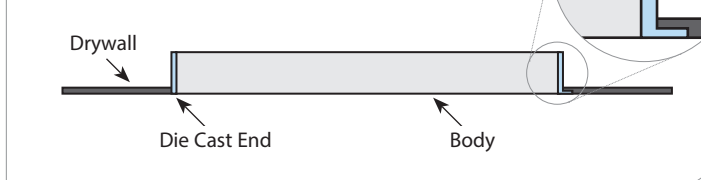

### WALL-TO-WALL

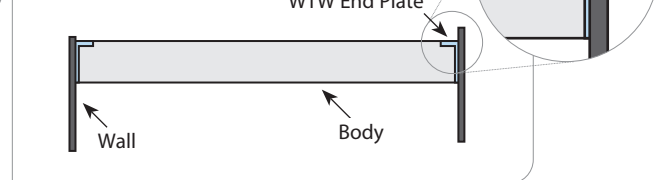

## SENSOR PLATE





TELESCOPING FILLER

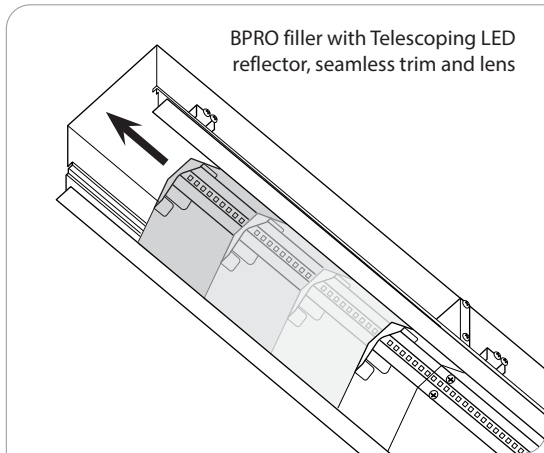

MOUNTING LOCATIONS

**T-BAR**

- ⊙ Coaxial 7/8" K.O / 1/2" K.O
- ⊕ 7/8" K.O
- Mounting Hole for 1/4-20 Rod (By Others)

**HARD CEILING**

**ROUGH-IN DIMENSIONS:**

LENGTH	NOMINAL + 1/4"	WIDTH
2'	25 1/4"	5 1/4"
3'	37 1/4"	
4'	49 1/4"	
5'	61 1/4"	
6'	73 1/4"	
7'	85 1/4"	
8'	97 1/4"	

## BionicPro5 Batwing Vs. Top 5" Competitor (Satin Lens)

### SINGLE OFFICE

#### BionicPro5



#### Top Competitor

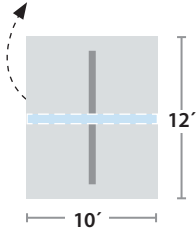

	BionicPro5	Competitor
LPW	131	113
<b>SPACING CRITERIA</b>	<b>1.95</b>	<b>1.2</b>
MAX/MIN	1.7	2.3
W/SQ. FT.	.38	.4
FC AVERAGE	27	29

9' ceiling .85 l/f BionicPro5—5.7w/ft Competitor—6w/ft Footcandles at 30" working plane

### OPEN OFFICE

#### BionicPro5



#### Top Competitor

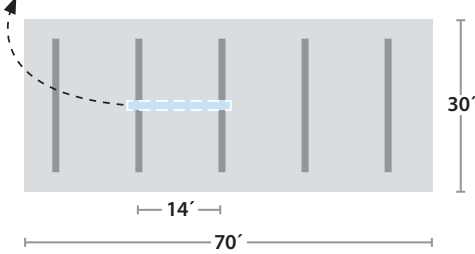
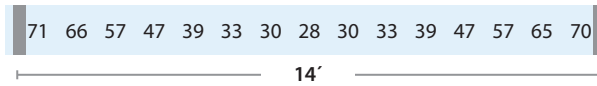
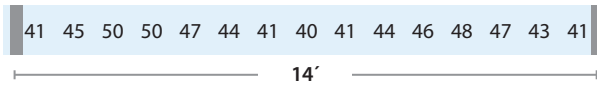

	BionicPro5	Competitor
LPW	131	113
<b>SPACING CRITERIA</b>	<b>1.95</b>	<b>1.2</b>
MAX/MIN	2.2	3.9
MAX/MIN BETWEEN ROWS	1.2	2.5
W/SQ. FT.	.36	.38
FC AVERAGE	36	37

9' ceiling .85 l/f BionicPro5—5.7w/ft Competitor—6w/ft Footcandles at 30" working plane



## Smooth, flat wall washing (WWF)

Our patent-pending Trubeam™ optics redirect light in an ideal flat wall wash for smooth, even illumination.

	Watts/ Ft.	Ceiling Height	Average Illuminance	Max/Min	Max/Min Ratio
Medium Output - 625 lumens/ft	6	9'	18	33/12	2.7

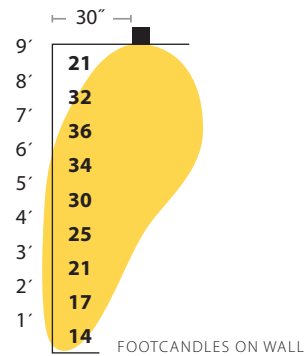

## Focal glow wall washing (WWG)

Pique interest by giving works of art 'pop' — more light at eye level

	Watts/ Ft.	Ceiling Height	Average Illuminance	Max/Min	Max/Min Ratio
Medium Output - 625 lumens/ft	6	9'	18	33/12	2.7

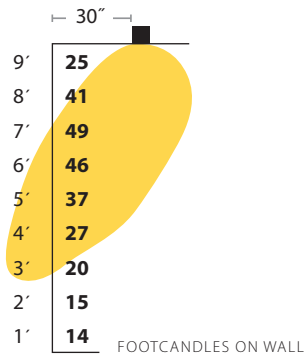

## BionicPro to Bionic/P23-43 Optics Crossing Matrix



	Satin	Batwing	Flat Wall Wash	Focal Glow Wall Wash
BionicPro	SAL	BTW	WWF	WWG
Bio2 / P23 = BionicPro3	SAL	MBW	MWW/D1W	—
Bionic4 / P43 = BionicPro4	SAL	ABW/D1X	—	AWL/D1W





LM79 & TM30 DATA:

	MEASURED CCT	MEASURED LUMENS	CRI	R9	DuV	SPD	TM30 — COLOR VECTOR	TM30 — COLOR DISTORTION
<b>LED27</b>	2680	80%	93	58	0.001		 89 Rf	 97 Rg
<b>LED3</b>	3042	95%	82	6	0.001		 81 Rf	 92 Rg
<b>LED3-90</b>	3016	85%	93	61	0.000		 88 Rf	 96 Rg
<b>LED35</b>	3482	100%	82	3	0.002		 81 Rf	 92 Rg
<b>LED35-90</b>	3417	85%	93	67	0.000		 88 Rf	 96 Rg
<b>LED4</b>	3952	102%	82	4	0.003		 81 Rf	 92 Rg
<b>LED4-90</b>	3882	85%	92	67	0.003		 87 Rf	 96 Rg
<b>LED5-90</b>	4889	85%	94	84	0.002		 86 Rf	 95 Rg