



## 3G-4RPE

### 3.5" PERIMETER

Narrow 3.5" aperture with one piece extruded aluminum housing

Designed for continuous runs in 1' increments as standard 12" fully illuminated end filler option is field cuttable for odd lengths

Multiple lumen output options with performance up to 132 lumens per watt

Lens position available in flush, 1", 2", and 3" regressed options  
1% dimming standard with several integral driver options

### ORDERING INFORMATION

<b>PROJECT:</b>		<b>TYPE:</b>	
<b>CATALOG#:</b>	3G-4RPE-L500-H90-40K-UNV-DIM-XTR-FL-EF-S(5')	<b>DATE:</b>	Jul-19-2021
		<b>QTY:</b>	1

<b>STANDARD PRODUCT</b>	<b>TUNABLE WHITE 3GT</b> <b>RGBW 3GB</b>				
<b>CAT. NO</b>	<b>LUMEN OUTPUT</b>	<b>CRI</b>	<b>COLOR TEMP</b>	<b>VOLTAGE</b>	<b>DRIVER</b>
3G-4RPE	<b>L250 - LOW OUTPUT</b> <b>L500 - MEDIUM OUTPUT</b> <b>L750 - HIGH OUTPUT</b> <b>L1000 - VERY HIGH OUTPUT</b>	<b>S80 - 83+ CRI</b> <b>H90 - 93+ CRI</b>	<b>27K - 2700K</b> <b>30K - 3000K</b> <b>35K - 3500K</b> <b>40K - 4000K</b>	<b>UNV - 120/277V</b> <b>347 - 347V</b>	<b>DIM - 0-10V (STANDARD 100-1%)</b> <b>D01 - 0-10V (eldoLED 100-0.1%)</b> <b>DALI - DALI (eldoLED, 100-1%)</b> <b>DHL2 - LUTRON HI-LUME LDE1 (100-1%)</b>
<b>FLANGE TYPE</b>	<b>LENS POSITION</b>	<b>OPTIONS</b>	<b>RUN TYPE</b>		
<b>WT - WHITE TRIM FLANGE</b> <b>XTR - TRIMLESS</b> <b>FX - FLANGELESS</b> <b>GCX - GRID CEILING (UNIVERSAL MOUNT)</b>	<b>FL - FLUSH</b> <b>RG1 - 1" REGRESSED</b> <b>RG2 - 2" REGRESSED</b> <b>RG3 - 3" REGRESSED</b>	<b>NONE</b> <b>CP - CHICAGO PLENUM</b> <b>DASY - ASYMMETRIC OPTIC</b> <b>EF - END FILLER (FOR ODD LENGTHS)</b> <b>EMB - EMERGENCY BATTERY (INTEGRAL)</b> <b>EMC - EMERGENCY CIRCUIT</b>	<b>S - STRAIGHT</b> <b>5' (5' LONG)</b> <input checked="" type="checkbox"/> <b>L - L-SHAPE</b> <b>U - U-SHAPE</b>		

### PERFORMANCE AND PHOTOMETRY BASED ON 4' LENGTH (83+ CRI AND 3500K SOURCE)

LENS POSITION	DELIVERED LUMENS (LM/FT)	SYSTEM WATTS (W/FT)	EFFICACY (LPW)
<b>FLUSH</b>	250	1.9	129
	500	3.9	129
	750	6.0	127
	1000	8.1	123
<b>1" REGRESSED</b>	250	1.9	122
	500	3.9	125
	750	6.0	124
	1000	8.1	120
<b>2" REGRESSED</b>	250	1.9	118
	500	3.9	123
	750	6.0	122
	1000	8.1	119
<b>3" REGRESSED</b>	250	1.9	115
	500	3.9	121
	750	6.0	121
	1000	8.1	119
<b>ASYMMETRIC</b>	250	1.9	131
	500	3.9	132
	750	6.0	128
	1000	8.1	124
<b>LUMEN OUTPUT ADJUSTMENT FACTORS</b>	<b>CCT</b>	<b>Multiplier</b>	
	2700K	0.94	
	3000K	0.97	
	3500K	1.00	
	4000K	1.01	
<b>EFFICACY (LPW) ADJUSTMENT FACTOR</b>	<b>CRI</b>	<b>Multiplier</b>	
	93+	0.88	

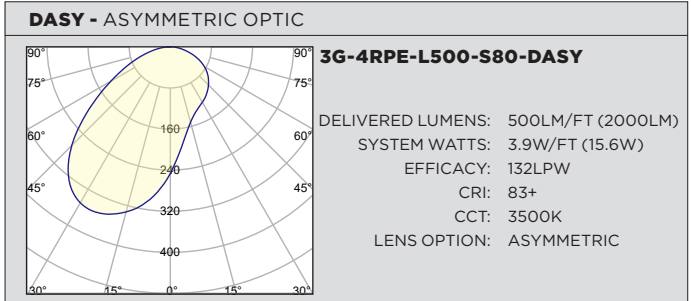
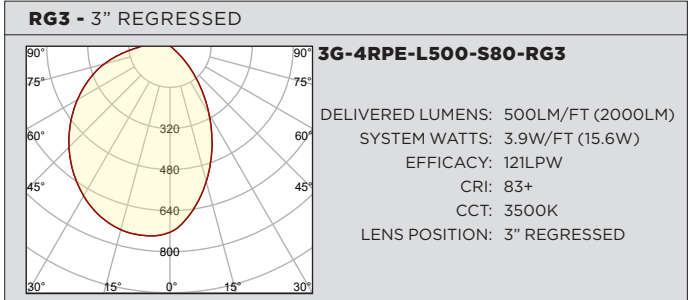
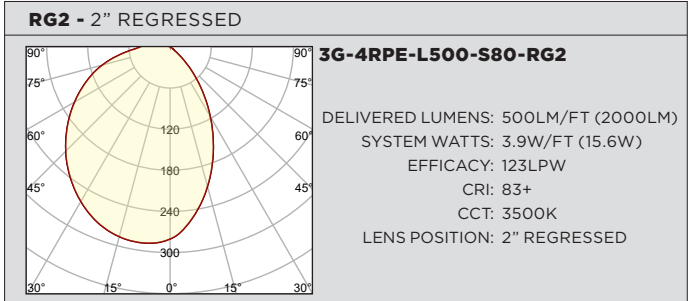
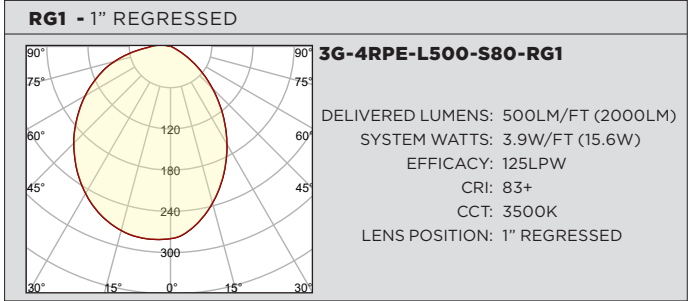
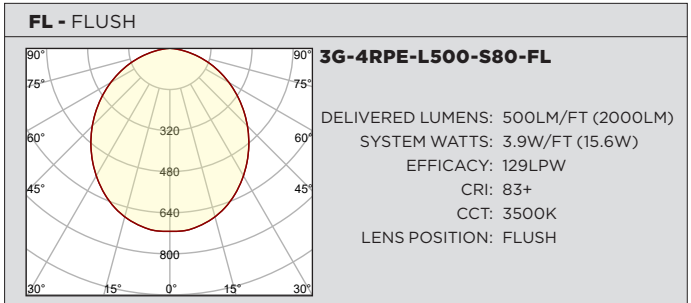

**TECHNICAL****HOUSING**

Extruded aluminum housing with narrow 3.5" aperture  
Individual units and continuous runs available in 1' increments  
12" fully illuminated end filler option is field cuttable for odd lengths  
Trim flange with matte white powder coated finish and minimal 0.400" overlap  
Trimless model features a satin coat mudding flange for seamless ceiling  
24-gauge LED reflector with high reflectance white powder coated finish  
Standard polyester powder coated matte white finish

**OPTICS**

Extruded, satin acrylic lens designed for optimal performance and glare control. Up to 8' continuous  
Lens position available in flush, 1", 2", and 3" regressed options  
High performance asymmetric optics available

**ELECTRICAL**

Luminaires are pre-wired with factory installed quick connects and branch circuit wiring  
Standard 0-10V, constant current drivers with 100-1% dimming range and >0.9 power factor  
Standard 120/277V universal voltage drivers. Optional 347V, 0-10V drivers  
Lutron EcoSystem and eldoLED DALI options available with 100-1% dimming range  
All drivers are integral and easily accessible through luminaire aperture  
Minimum 4' and maximum 6' length for each integral emergency battery. 10W output for 90 minutes

**LED SYSTEM**

Proprietary LED system with color consistency <3 SDCM  
Available in 27K, 30K, 35K, and 40K  
Standard 83+CRI. Optional 93+CRI  
R9 value of 56 for 93+CRI  
L90 >60,000 hours  
5 Year Warranty

**MOUNTING**

New construction housing suspended via 1/4" threaded rod or suspension cables (by others)  
Trim fixture designed for use in drywall, wood, and other architectural ceiling materials  
Trimless fixture designed for use in drywall, mud-in ceiling applications  
Flangeless fixture designed for use in wood ceilings  
Suitable for various grid ceiling applications (see mounting details)  
Suitable for various architectural ceilings (see mounting details)  
Standard mounting available in flush and regressed options up to 3". Consult 3G for modification  
Fixture weight: +/- 3 lbs/ft

**LISTING**

ETL listed and tested to cUL standards. Suitable for dry and damp locations

**WARRANTY**

5 Year Warranty on LED and drivers  
Manufacturer 1 Year Warranty for defects in material and workmanship under normal use  
Ambient temperature at fixture should not exceed 25°C

### DRAWINGS AND DIMENSIONS

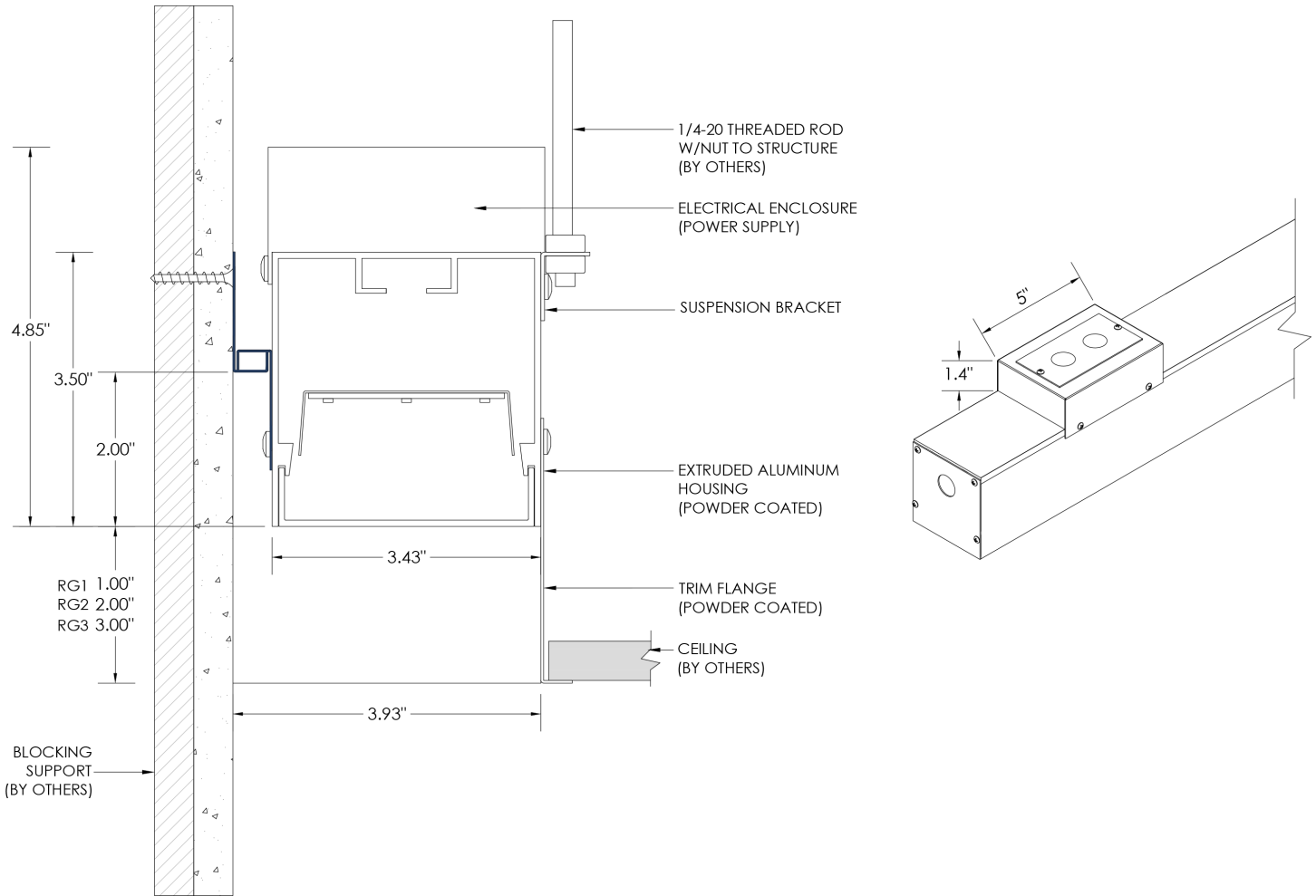

### LENS POSITION

**FL - FLUSH**

**RG1 - 1" REGRESSED**

**RG2 - 2" REGRESSED**

**RG3 - 3" REGRESSED**

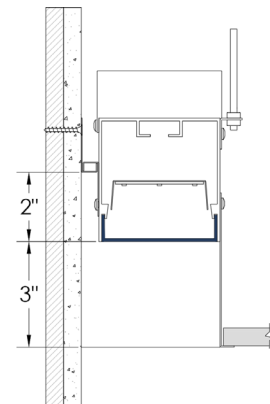
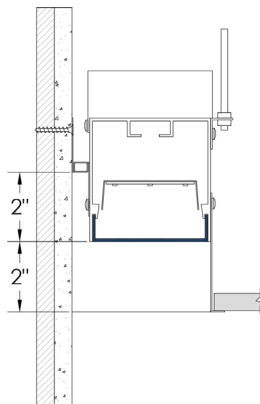
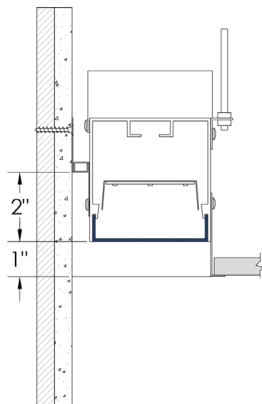
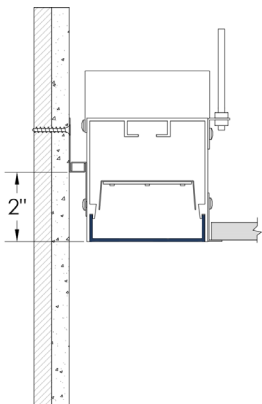

### HARD CEILING MOUNTING TYPES

#### FLUSH

**WT - TRIM**

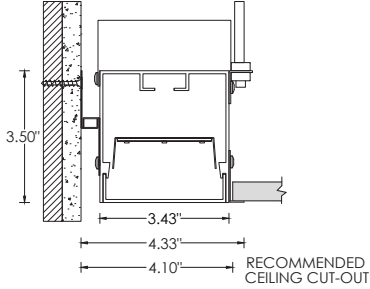

**XTR - TRIMLESS**

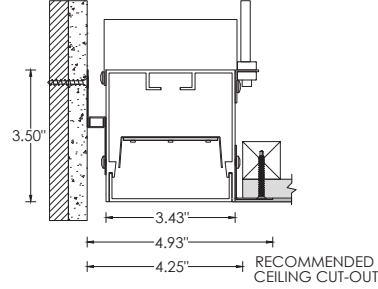

**FX - FLANGELESS**

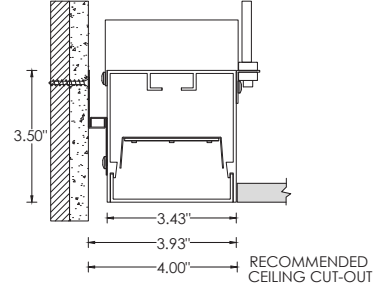

#### 2" REGRESSED

**WT - TRIM**

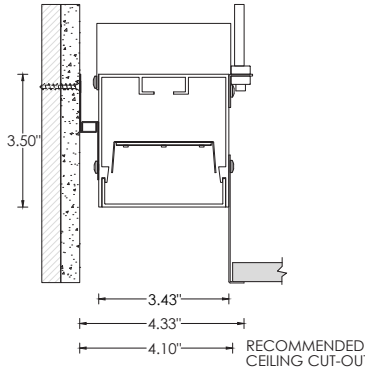

**XTR - TRIMLESS**

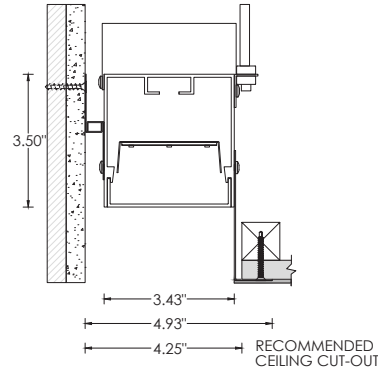

**FX - FLANGELESS**

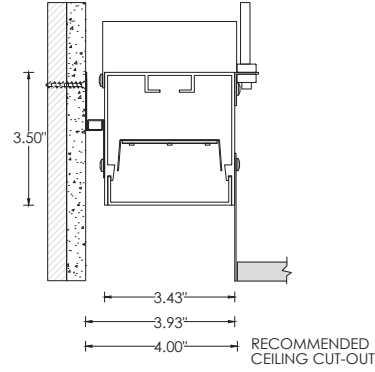

### GRID CEILING MOUNTING TYPES

#### FLUSH

**9L - 9/16" LAYIN**

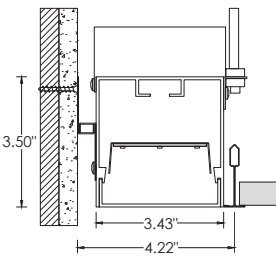

**9TG - 9/16" TEGULAR**

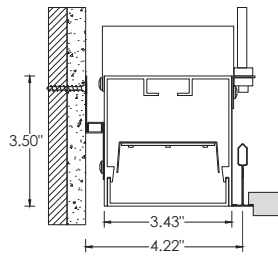

**15L - 15/16" LAYIN**

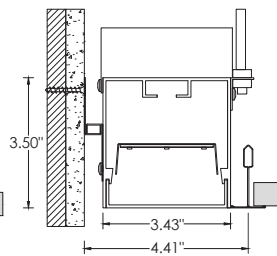

**15TG - 15/16" TEGULAR**

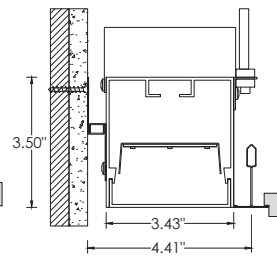

**9ST - 9/16" SLOT TEE TEGULAR**

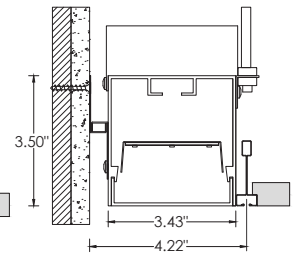

#### 2" REGRESSED

**9L - 9/16" LAYIN**

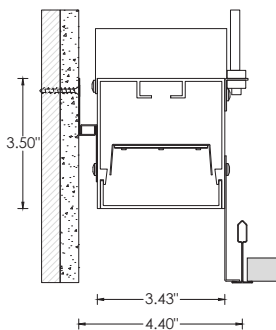

**9TG - 9/16" TEGULAR**

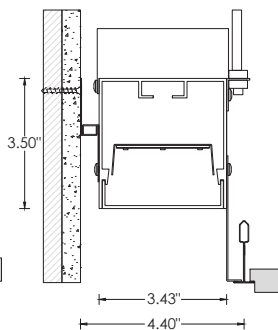

**15L - 15/16" LAYIN**

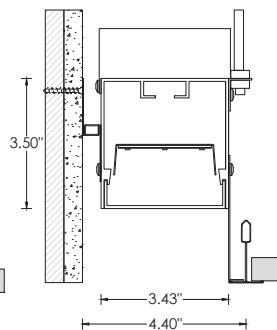

**15TG - 15/16" TEGULAR**

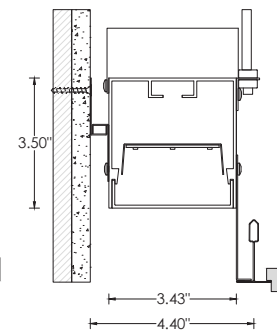

**9ST - 9/16" SLOT TEE TEGULAR**

